

Courses & Dist. Beging
at N.W. Corner

S 32 E	70	
N 84 E	9	
N 4 W	9.6	
N 35 W	11	
N 26 W	22	B. Walnut
N 10 W	26	
N 65 W	12	Butterwood
S 53 W	17.5	

Contg. 7 acs. 30 ps.

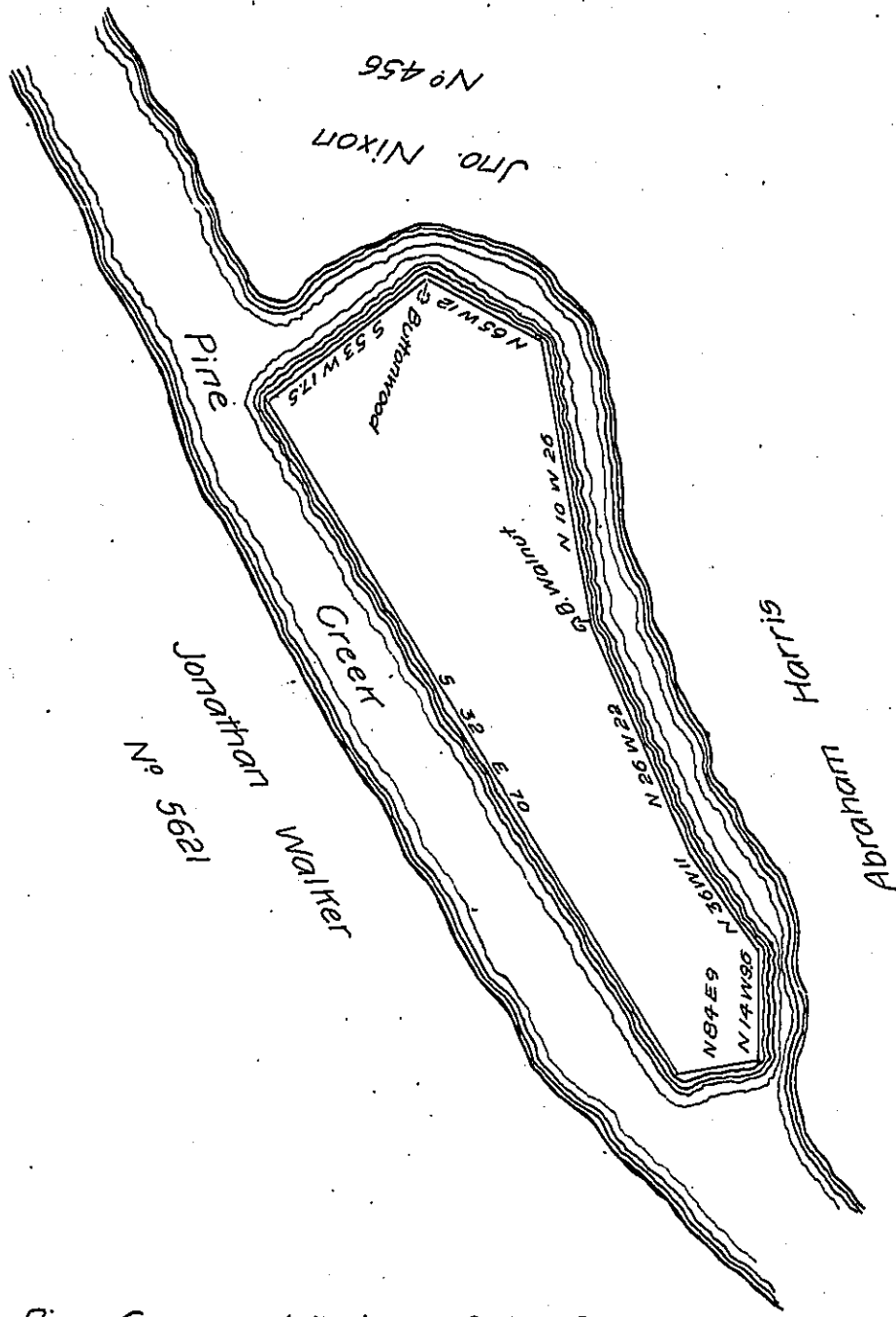

Situate in Pine Creek a tributary of the Susquehanna River, in
Cummings Township Lycoming County, (formerly known by the name
of Harris' Island.) Surveyed on the 10th day of February 1858 in pur-
suaunce of an island warrant granted to John Crist on the 27th day
of January 1858. Containing Seven acres and thirty perches neat
Measure.

To John Rowe Esquire

Ja^s W. Heylman Co. Surveyor.

Surveyor General.

IN TESTIMONY that the above is a copy of the original remaining on file in
the Department of Internal Affairs of Pennsylvania, made
conformably to an Act of Assembly approved the 16th day of
February, 1833, I have hereunto set my Hand and caused
the Seal of said Department to be affixed at Harrisburg,
this eighth day of September 1904.

James D. Brown
Secretary of Internal Affairs.